

Courtesy Of Darin B Baxandall Of RE/MAX Elite

# \$539,000 - 34 Foxboro Close, Sherwood Park

MLS® #E4459616

**\$539,000**

3 Bedroom, 3.00 Bathroom, 1,419 sqft  
Single Family on 0.00 Acres

Foxboro, Sherwood Park, AB

**STUNNING, GORGEOUS, METICULATE +  
COMPLETLEY RENOVATED 4 LEVEL SPLIT!**

This perfect family friendly home in Foxboro is PERFECTION for you and your family! From top to bottom this home will impress you! Greeting you is a cozy front room leading you to the most spectacular kitchen with S/S appliances, giant quartz island and an abundance of custom, white cabinets. Perfect dining area overlooking patio doors to large, treed + private backyard. Upstairs boasts a master bedroom w/ 3pce ensuite & a large custom closet + 1 other kids sized bedrooms & 4pce bathroom. Lovely glass panel to lower living space w/perfect sized family room and exquisite stone floor to ceiling fireplace + one more childrens bedroom & 4pce bathroom. Finished basement completes this home with large laundry area + additional rec room/workout room space. There's so many extras to enjoy! This home will check off all the boxes! If you're looking for a dream home in Foxboro look no further!

Built in 2000

## Essential Information

|          |           |
|----------|-----------|
| MLS® #   | E4459616  |
| Price    | \$539,000 |
| Bedrooms | 3         |

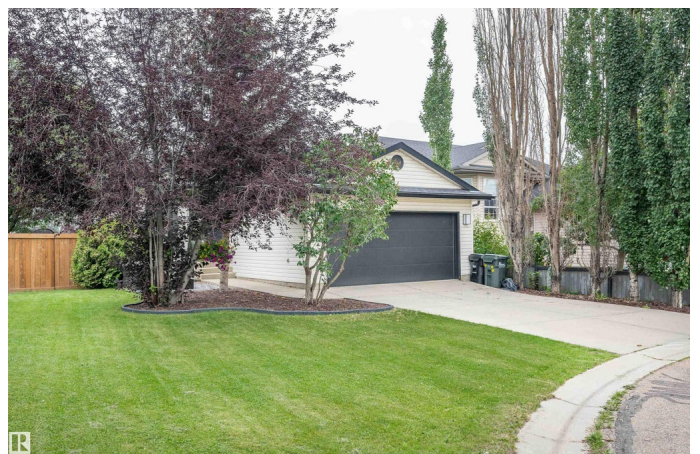
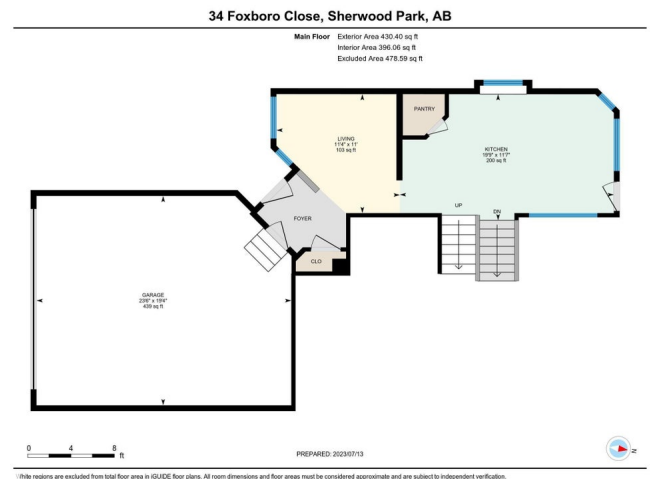

|                |                        |
|----------------|------------------------|
| Bathrooms      | 3.00                   |
| Full Baths     | 3                      |
| Square Footage | 1,419                  |
| Acres          | 0.00                   |
| Year Built     | 2000                   |
| Type           | Single Family          |
| Sub-Type       | Detached Single Family |
| Style          | 4 Level Split          |
| Status         | Active                 |

### Community Information

|             |                  |
|-------------|------------------|
| Address     | 34 Foxboro Close |
| Area        | Sherwood Park    |
| Subdivision | Foxboro          |
| City        | Sherwood Park    |
| County      | ALBERTA          |
| Province    | AB               |
| Postal Code | T8A 6C1          |

### Amenities

|           |                                |
|-----------|--------------------------------|
| Amenities | Exercise Room, No Smoking Home |
| Parking   | Double Garage Attached         |

### Interior

|                   |  |
|-------------------|--|
| Interior Features | ensuite bathroom   |
| Appliances        | Dishwasher-Built-In, Dryer, Refrigerator, Stove-Electric, Washer, Window Coverings |
| Heating           | Forced Air-1, Natural Gas  |
| Stories           | 4  |
| Has Basement      | Yes  |
| Basement          | Full, Finished   |

### Exterior

|                   |   |
|-------------------|---|
| Exterior          | Wood, Vinyl   |
| Exterior Features | Cul-De-Sac, Fenced, Fruit Trees/Shrubs, Landscaped, Playground Nearby, Schools, Shopping Nearby, Treed Lot, See Remarks |
| Roof              | Asphalt Shingles  |
| Construction      | Wood, Vinyl   |
| Foundation        | Concrete Perimeter  |

## School Information

Middle                   FR Haythorne  
High                     Bev Facey

## Additional Information

Date Listed             September 26th, 2025  
Days on Market       28  
Zoning                 Zone 25

DATA IS DEEMED RELIABLE BUT IS NOT GUARANTEED ACCURATE BY THE REALTORS® ASSOCIATION OF EDMONTON. COPYRIGHT 2025 BY THE REALTORS® ASSOCIATION OF EDMONTON. ALL RIGHTS RESERVED. Trademarks are owned or controlled by the Canadian Real Estate Association (CREA) and identify real estate professionals who are members of CREA (REALTOR®, REALTORS®) and/or the quality of services they provide (MLS®, Multiple Listing Service®)

Listing information last updated on October 23rd, 2025 at 11:18pm MDT